

# User Manual

LG RESU HOME App

V1.0-2021-11-20

**Copyright ©LG Energy Solution Ltd., 2021. All rights reserved**

No part of this manual can be reproduced or transmitted to the public platform in any form or by any means without the prior written authorization of LG Energy Solution.

**Trademarks**

 **LG Energy Solution** and other LG Energy Solution trademarks are trademarks of LG Energy Solution Australia Pty Ltd. All other trademarks or registered trademarks mentioned in this manual are owned by LG Energy Solution Australia Pty Ltd.

**Notice**

The information in this user manual is subject to change due to product updates or other reasons. This guide cannot replace the product labels or the safety precautions in the user manual unless otherwise specified. All descriptions in the manual are for guidance only.

# 1 About This Manual

- This manual introduces commonly used operations in LG RESU HOME App.
- Before setting any parameters, read through the app and the inverter user manual to learn the product functions and features. When the inverter parameters are set improperly, the inverter may fail to connect to the utility grid or fail to connect to the grid in compliance with related requirements and damage the battery, which will affect the inverter's power generation.
- This manual is subject to update without notice. For more product details and latest documents, please visit <https://www.lgessbattery.com/au/home-battery/product-info.lg?sn=362> for PC, <https://www.lgessbattery.com/m/au/home-battery/product-info.lg?sn=362> for mobile.

## 1.1 Target Audience

This manual applies to trained and knowledgeable technical professionals. The technical personnel has to be familiar with the product, local standards, and electric systems.

## 1.3 Updates

The latest document contains all the updates made in earlier issues.

### V1.0 2021-11-20

- First Issue

## 2 Product Introduction

This manual introduces how to create plants, and monitor plant status via the LG RESU HOME App.

### 2.1 Obtain an Account

Contact the supplier to obtain an organization account and password. Or contact the after-sales service to obtain the account and password if you purchased directly from the manufacturer. Or register an account following the steps below.

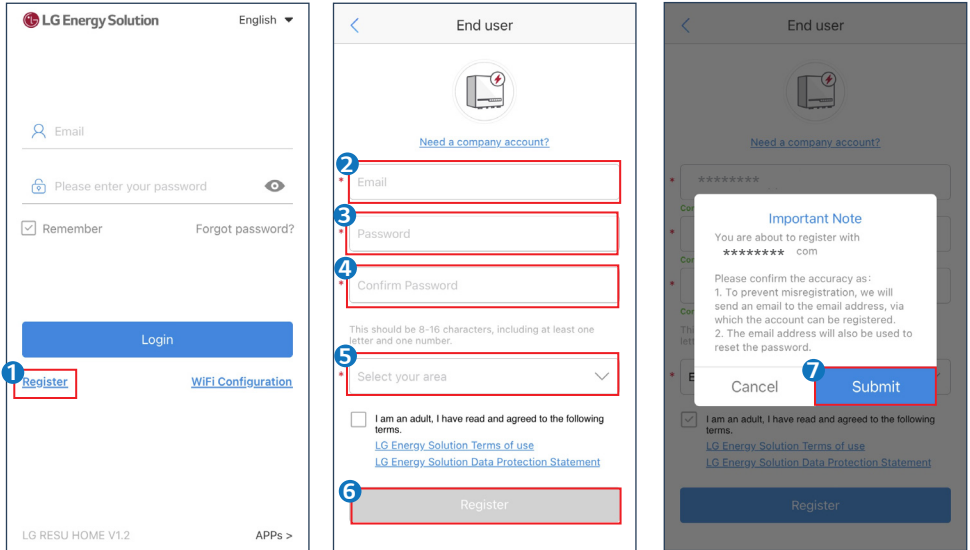

## 2.2 Create a Plant

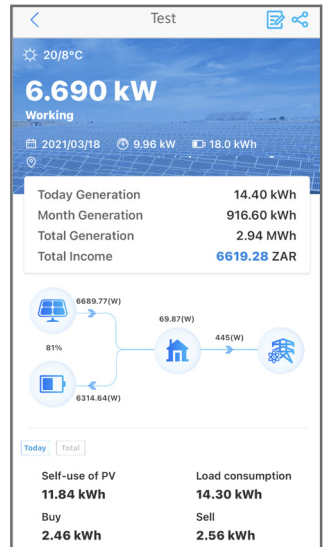
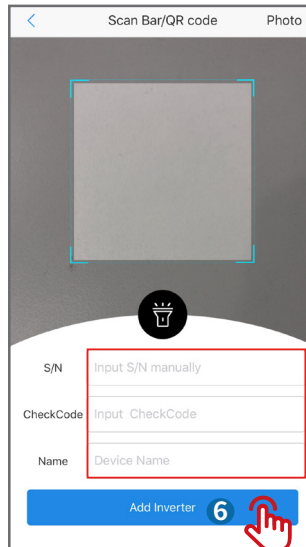
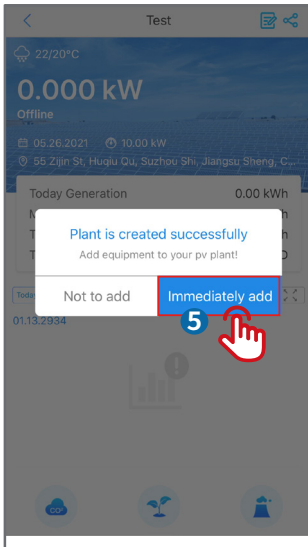
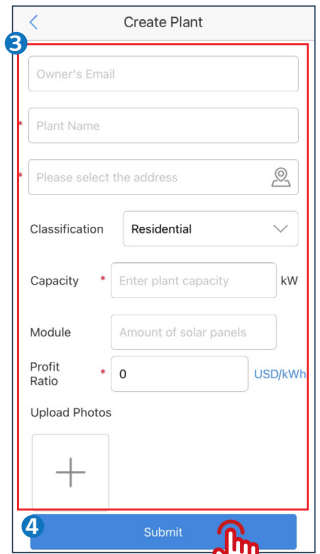
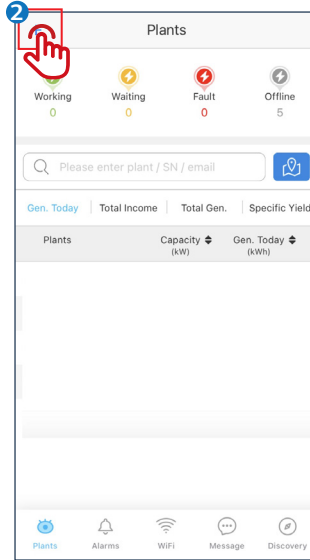
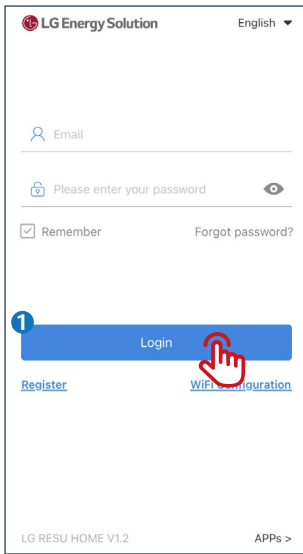

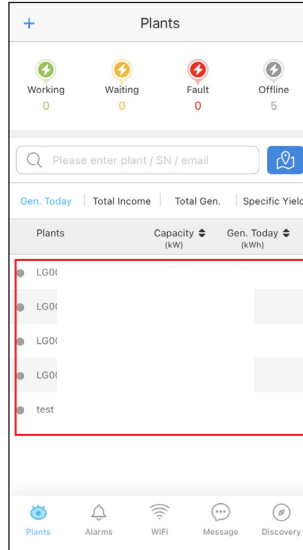
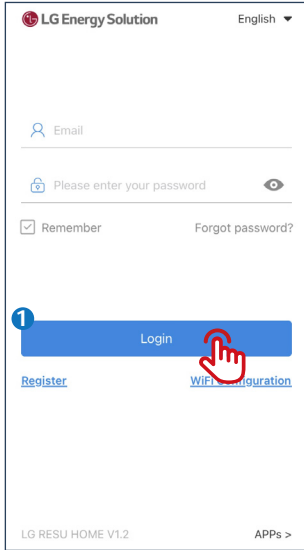

## 2.3 Monitor Plant



## **LG Energy Solution Australia Pty Ltd**

---

 Unit 12,35 Dunlop Rd,Mulgrave,VIC 3170

 T: 1300 178 064 [AEST Business hours]

 [www.lghomebattery.com/au](http://www.lghomebattery.com/au)

 [essserviceau@lgensol.com](mailto:essserviceau@lgensol.com)